



STRICTLY.

KITCHEN + BATH

Kitchen Faucet

PULL-DOWN KITCHEN FAUCET INSTALLATION INSTRUCTIONS

Notes Before Installation:

1. Please check that all components are present.
2. Shut off water supply. Remove the old faucet and flexible hose. Clean basin surface with a non abrasive cleaner in preparation for the new faucet.
3. Ensure water pressure is between 20-125 PSI (includes combination of hot and cold feed lines).
4. Appearance of product in the manual may not represent what you exactly purchased. if you are facing difficulties of assembly, please contact a professional plumber.
5. If you will be away from home for an extended period you should shut off the main water supply.

Daily Maintenance:

1. Use a soft cloth and vinegar to remove water spots.
2. When water stream is not optimum, please check the aerator (if present) regularly to avoid calcium building up.
3. DO NOT use caustic cleaning products as they will break the surface of the faucets.
4. Acceptable cleaners include vinegar or mild non-abrasive liquid detergents.

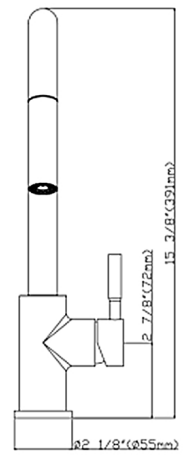
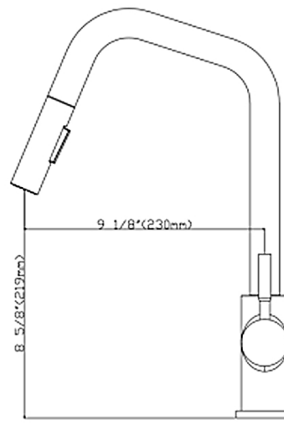

Tools we will need:

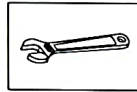

Adjustable Wrench

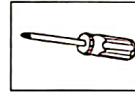

Philips Screwdriver

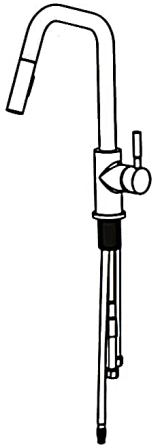

1. Remove the rubber washer, metal washer and locking nut from the faucet.

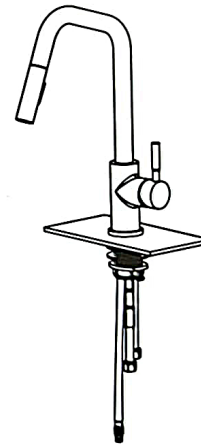

2. Position the faucet in the countertop hole.

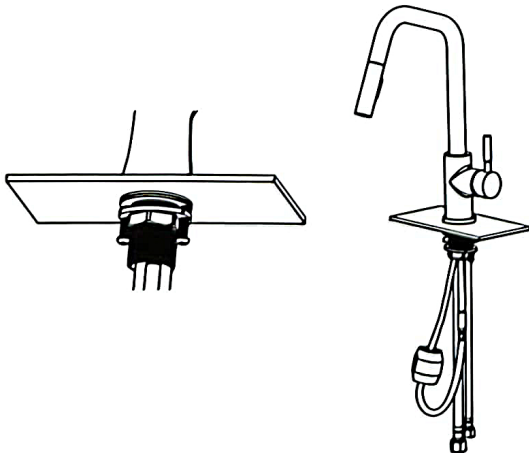

3. Manually assembly the hot and cold flexible hoses. DO NOT use a wrench to tighten hoses as it may damage the hose. Then assembly rubber washer, followed by the metal washer and lock-nut. Tighten until the faucet is secure.

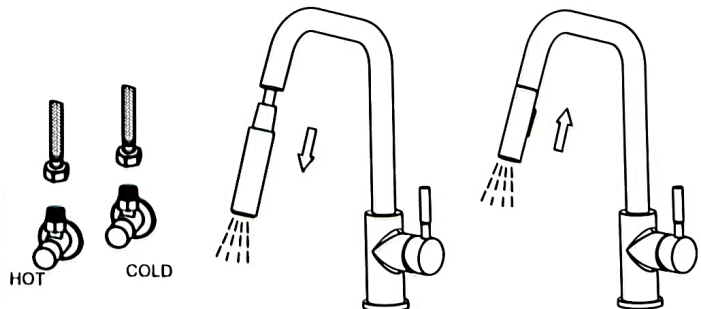

4. Attach flexible hoses to water supply.
5. Remove the shower head and turn on faucet for 1-minute to flush debris from faucet and feed lines. Turn faucet off and re-assembly shower head.